

# PRECASTER CX80

## GO BEYOND THE NORM

80-METERS LASER DISTANCE METER

# CX80

MEASURING RANGE: 0.05M-80M



## THE ORDINARY LASER DISTANCE METER BUILT IN EXTRAORDINARY POWERS

The CX80 gives a long measuring range, and it is close with what you get with the Precaster CA700 series. It is a vital tool that changes the face of your work experience. The product aligns with the ISO standards, and this makes it a step ahead in every sense. Convenience and accuracy are richly blended as you allow the measuring meter to perform at full capacity.

The trendy design makes it a unique device that can hold its own in any work environment. Here are some robust features of this product:

- ★ It comes with 1/4" camera thread for stable measurement
- ★ It aligns with dual ISO Standards
- ★ The casing design makes it ideal for all work situations
- ★ The multi-function pintail gives you the edge for the peculiar demands of each project
- ★ It is easy to use and so much more.

**IP54**  
INGRESS PROTECTION  
WATER JET & DUST TIGHT



## CREATE THE CONVENIENT AND ACCURATE MEASUREMENTS WITH THE STAINLESS PINTAIL

The multi-function pintail gives you the opportunity to boost your measuring experience. The stainless pintail is a unique addition in this range. The pintail has 3 different positions that can help you achieve your goals. It gives you the dynamic outlet to get your measurements done in a quick and very fast way, by engaging the Pintail.



## STEADY & ACCURATE MEASUREMENTS WITH THE TRIPOD THREAD

The small 1/4" thread at the back of the unit is used to make an attachment with your small camera tripod. It is perfect when you use it for indirect measurements and long distance measurements. It gives more stability and accuracy when you use it. It is something that everyone who wants to explore new possibilities will be excited about. This is the key to accurate measuring experiences.

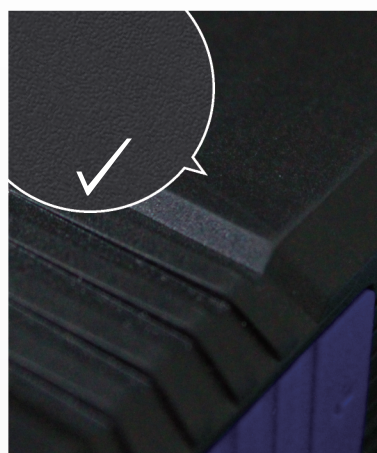

## GRAB THE SOFT GRIPS AND MEASURE RIGHT ON JOB-SITES

Most of the components that make the laser measuring meter a unique gadget comes down to this. You use the soft grips to measure accurately in your various projects. The flexibility to move with your palm and hands allows you to stay in line with contemporary realities. You can be safe from any hazards that come from rigorous applications as was the custom in older models of laser measuring meters.

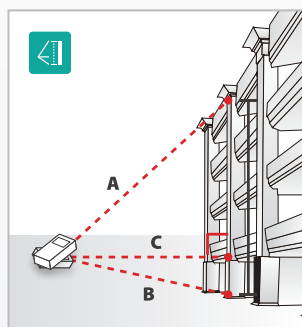
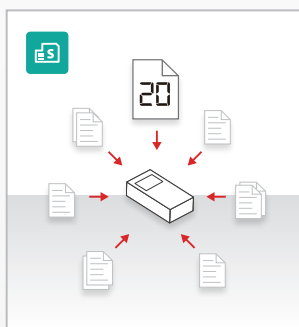
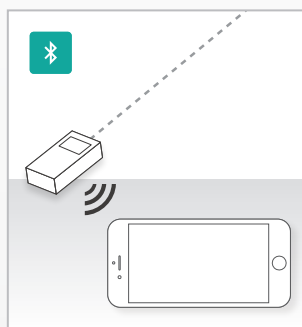

## EVERY APPLICATIONS YOU NEED ARE ALL AROUND

There are so many things that make the job easy for you. With the quick access to various apps, you can take your brief to a new level. Every application you need is packed in a unique setting that allows you to carry out your job with ease. Every app gives the savvy user in edge to operate in their ever-growing and dynamic industry. The apps give you the positive shift that you need to get the job done.



### ACCESSORIES

- CX80 | Laser Distance Meter
- Operation Manual
- Carrying Case
- AAA Battery x 2
- Safety Strap

### SPECIFICATION

Measuring Range	0.05 m ~ 80 m
Resolution	0.001 m
Accuracy	±1.5 mm
Measuring Speed	0.5 seconds
Laser Type	650 nm, Class II, < 1 mw
Beam Size	25 mm @ 30 m
Battery	2 * AAA Batteries
Battery Life	Up to 10,000 measures
Dimensions	116 * 48 * 31 mm
Operation Temperature	-5°C ~ 40°C
Storage Temperature	-20°C ~ 60°C
Automatic Power-Off	
-Laser	30 seconds
-Device	180 seconds

Dealer Stamp